

CABLE DRAWING: **CAB-0XXX (SALEM CODE)**

DRAWING TITLE:
SBC(TempMon) Internal Cable

DRAWING NO.: MWACAB-0038	DRAWN BY: DRC	DATE: 23-Dec-09	REV: A
		SHEET: 1 of 3	

Cable Detail:

Connectors:	Description	Parts (Qty)
TempMon	DE9 Female IDC	See Note1 Below(1)
ATIM-C	4-Way AMP Shell	See Note2 Below(1)
ATIM-C	AMP Shell Socket	See Note2 Below(4)
Conductors:		
Cable	Ribbon Cable, Flat, 10-Way	See Note2 Below(??)
Misc:		

Overall Length ??+/-5mm

Notes:

1. DE9 Female IDC connector can be supplied from Farnell #469-415. Any equivalent will be OK refer to data sheets supplied with this drawing.
2. 4-Way Shell can be supplied from Farnell #968-9230. Any equivalent will be OK refer to data sheets supplied with this drawing.
3. Socket Pin can be supplied from Farnell #973-300. Any equivalent will be OK refer to data sheets supplied with this drawing.
4. The ribbon cable can be supplied from RS #363-626 or PSI Stock# PC-0004. Any equivalent will be OK refer to data sheets supplied with this drawing.

Typical Drawing:

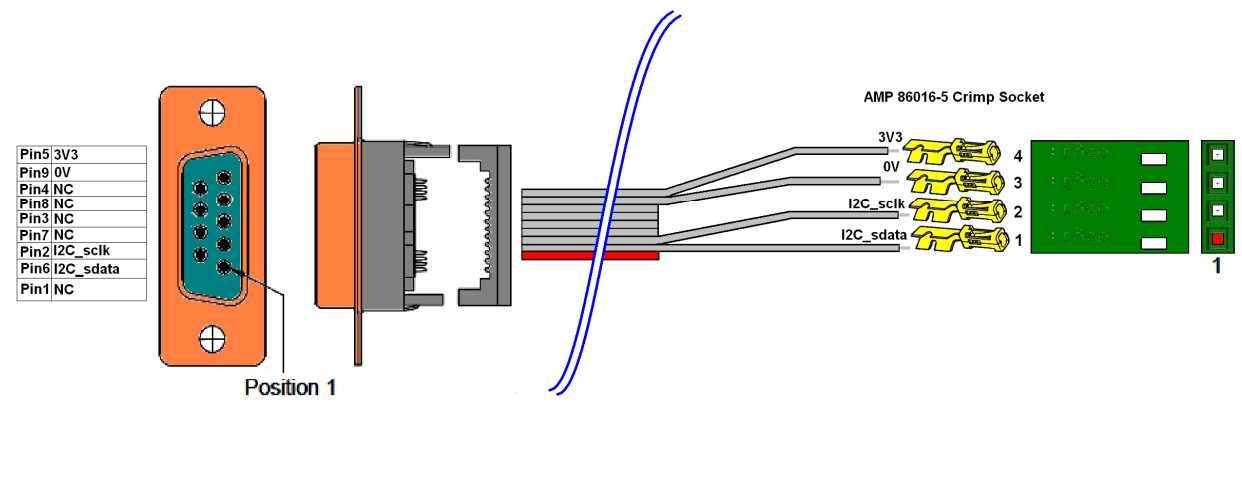

REVISION

Date	Rev	Remarks
23/12/09	A	Draft



CABLE DRAWING:

CAB-0XXX (SALEM CODE)

DRAWING TITLE:

SBC(TempMon) Internal Cable

DRAWING NO.:
MWACAB-0038

DRAWN BY:
DRC

DATE: 23-Dec-09

SHEET: 2 of 3

REV:

A

Pinouts Table:

TempMon Pins(9)		ATIM Control J23/J17 Pins(4)
1	NC	
6	I2C_sdata	1
2	I2C_sclk	2
7	NC	
3	NC	
8	NC	
4	NC	
9	0V	3
5	+3V3mcc	4

Connection Detail:

From: (SBC) TempMon I2C Connector
To: (SBC) ATIM-C Connector (J23 or J17)

REVISION

Date	Rev	Remarks
23/12/09	A	Draft

CABLE DRAWING: **CAB-0XXX (SALEM CODE)**

DRAWING TITLE:
SBC(TempMon) Internal Cable

DRAWING NO.: MWACAB-0038	DRAWN BY: DRC	DATE: 23-Dec-09	REV: A
		SHEET: 3 of 3	

Assembly Details:

Wire Preparation

The wire must be stripped to the dimension provided in Figure 2.

Do not nick, scrape, or cut the wire conductor during the stripping operation.

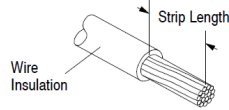

Figure 2

WIRE SIZE RANGE, (AWG)	INSUL DIA MAX.	STRIP LENGTH	WIRE BARREL		INSUL BARREL CRIMP WIDTH
			CRIMP HEIGHT	CRIMP WIDTH	
20	•	4.78-3.58	0.94-0.72	1.4	1.57
22	•	4.78-3.58	0.84-0.72		
24	•	4.78-3.58	0.83-0.64		
22	1.55	4.37-2.77	0.97-0.81	1.07	
24	1.55	4.37-2.77	0.86-0.71		
26	1.55	4.37-2.77	0.81-0.71		
26-30	1.22	4.37-2.77	0.74-0.64	1.4	1.4
27, 28	1.02	4.37-2.77	0.61-0.51	0.84	
30, 32	1.02	4.37-2.77	0.61-0.48		

Crimp Length

For optimum crimp effectiveness, the crimp must be within the area shown and must meet the crimp dimensions provided in Figure 3. Effective crimp length shall be defined as that portion of the wire barrel, excluding bellmouth(s), fully formed by the crimping tool.

Figure 3

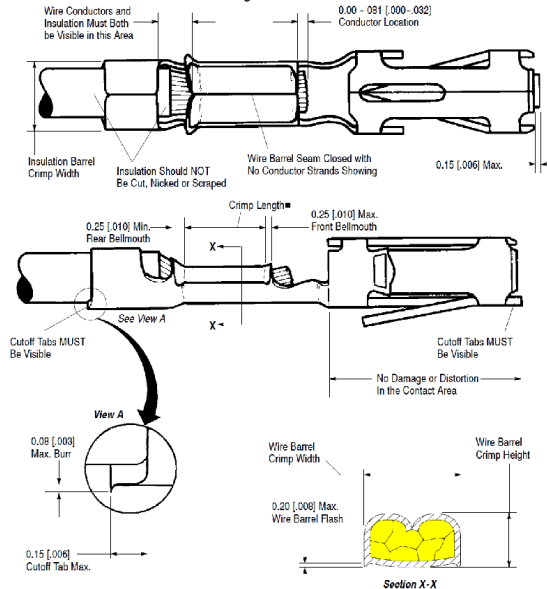

NOTE: Comparing a crimped contact to an uncrimped contact should reveal any fault that may have occurred to front shoulder or locking lances during crimping.

■ Effective crimp length shall be 2.67 mm minimum for 20-24 AWG wire, and 2.16 mm minimum for all other wire sizes; and is defined as that portion of the wire barrel fully formed by the tool, excluding the bellmouths.

REVISION

Date	Rev	Remarks
23/12/09	A	Draft

D Sub

Socket Connector

8300 Series



57

- Available in either preassembled or two piece covers
- Available in either open or closed end cover
- Improved metal strain relief — hooks directly to metal shell
- Low profile
- Four mounting options

Date Modified: September 29, 1999

TS-0235-17
Sheet 1 of 3

Physical

Insulation

Material: Glass Filled Polyester (PBT)
Flammability: UL 94V-0
Color: Gray

Contact

Material: Copper Alloy
Plating
Underplate: 100 μ " (1.27 μ m) Nickel — QQ-N-290, Class 2
Wiping Area: 30 μ " (0.76 μ m) Gold — MIL-G-45204, Type II, Grade C

Shell

Material: Steel
Plating: Tin

Strain Relief Material: Stainless Steel .016 (0.40) Thick

Wire Accommodation: 26 & 28 AWG Solid or Stranded

Marking: 3M Logo & Contact Position Numbers

Electrical

Current Rating: 1 A

Insulation Resistance: $> 1 \times 10^9 \Omega$ at 500 VDC

Withstanding Voltage: 1000 Vrms at Sea Level

Environmental

Temperature Rating: -55° to $+105^\circ$

UL File No.: E68080

3M Interconnect Solutions Division

6801 River Place Blvd.
Austin, TX 78726-9000

For technical, sales or ordering information call
800-225-5373

Contact Quantity	Dimensions					
	A	B	C	D	E	F ± .008
09	1.23 [31.2]	.64 [16.3]	.98 [24.9]	.46 [11.7]	.67 [17.0]	.70 [17.7]
15	1.56 [39.6]	.97 [25.6]	1.31 [33.3]	.76 [19.3]	.99 [25.2]	1.03 [26.2]
25	2.10 [53.3]	1.51 [38.4]	1.85 [47.0]	1.27 [32.3]	1.54 [39.1]	1.57 [39.9]
37	2.74 [69.6]	2.16 [54.9]	2.50 [63.5]	1.87 [47.5]	2.19 [55.6]	2.22 [56.4]

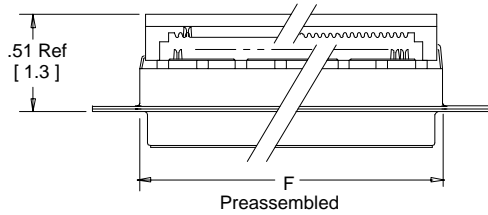

Note: Preassembled closed cover on Pin 1 side of connector.

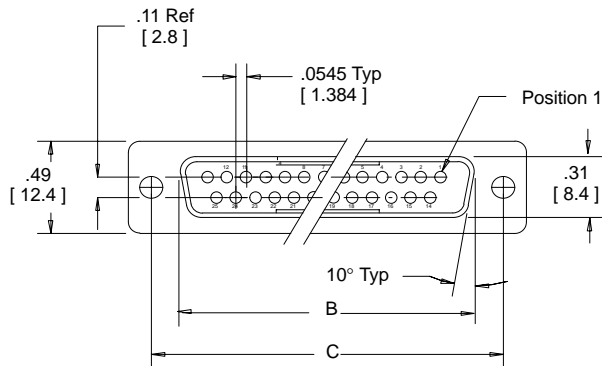
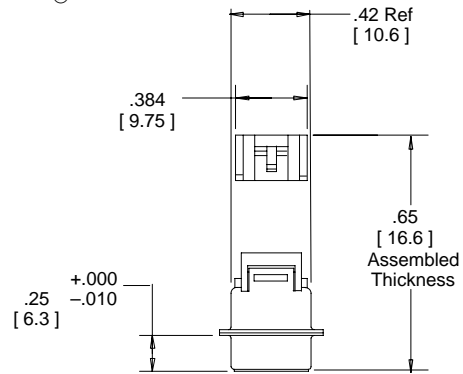
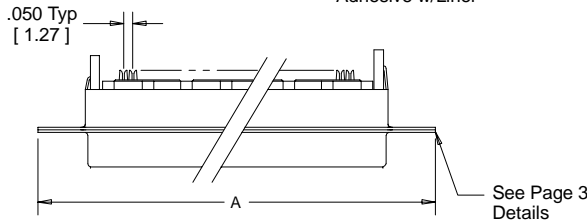
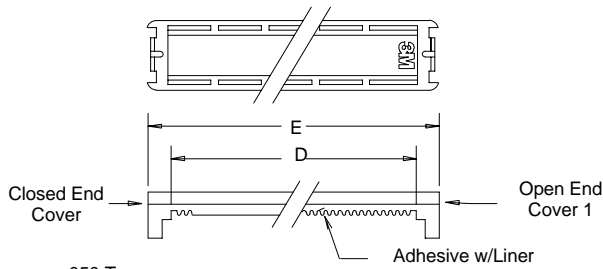

Inch
[mm]

Tolerance Unless Noted			
	.0	.00	.000
Inch	± .1	± .01	± .005

[] Dimensions for Reference only

Ordering Information

Connector 83XX-X00X

Contact Quantity

- Cover Style:
 6 = Open Cover
 7 = Closed Cover
 8 = Open Cover, w/o Adhesive, Preassembled
 9 = Closed Cover, w/o Adhesive, Preassembled

- Mounting Style:
 0 = ∅ .120 [3.05]
 3 = 4-40 UNC
 4 = M3

Strain Relief (Order Separately) 3448-8DXXA

- 09 = 9 Position
 15 = 15 Position
 25 = 25 Position
 37 = 37 Position

TS-0235-17
Sheet 2 of 3

D Sub Socket Connector

8300 Series

Mounting Method*	Contact Quantity	Dimensions						
		A1	B1	C1	D1	E1	F1	G1
Front	9	.87 [22.0]	.44 [11.2]	.98 [24.9]	.49 [12.5]	.51 [13.0]	.26 [6.6]	.12 [3.1]
	15	1.20 [30.5]	.60 [15.2]	1.31 [33.3]	.66 [16.8]			
	25	1.74 [44.2]	.87 [22.1]	1.85 [47.0]	.93 [23.6]			
	37	2.39 [60.7]	1.20 [30.5]	2.50 [63.5]	1.25 [31.8]			
Rear	9	0.81 [20.6]	.40 [10.2]	.98 [25.0]	.49 [12.5]	0.45 [11.4]	0.22 [5.8]	.12 [3.1]
	15	1.13 [28.7]	.57 [14.5]	1.31 [33.3]	.66 [16.8]			
	25	1.67 [42.4]	.84 [21.3]	1.85 [47.0]	.93 [23.6]			
	37	2.33 [59.2]	1.16 [29.5]	2.50 [63.5]	1.25 [31.8]			

* Front Mount—The connector is mounted in front of the panel.
Rear Mount—The connector is mounted behind the panel.

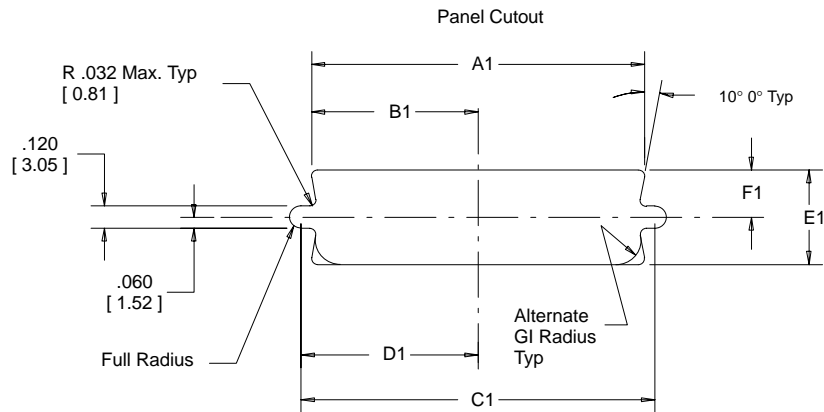

Mounting Styles

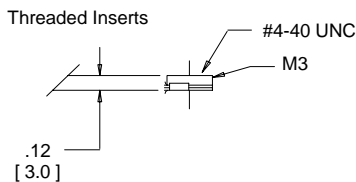
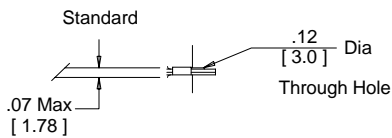

Strain Relief (Order Separately or with Connector)

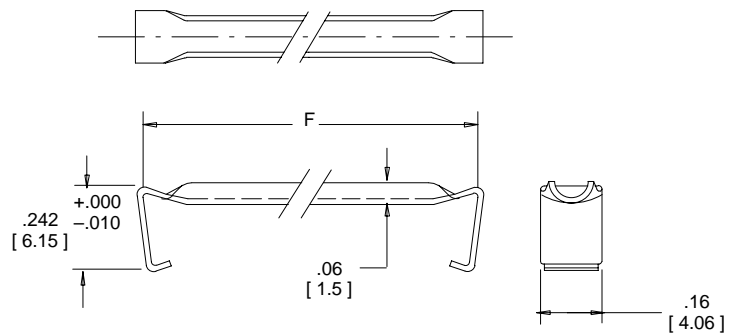

TS-0235-17
Sheet 3 of 3

3M Interconnect Solutions Division

6801 River Place Blvd.
Austin, TX 78726-9000

For technical, sales or ordering information call
800-225-5373

4

3

2

1

NUMMER 925 366
 VERWENDET FÜR E 92-9802
 WAR NR. -

ÄNDERUNGEN DIE DEM TECH-
 NISCHEN FORTSCHRITT DIENEN,
 BEHALTEN WIR UNS VOR

CAD-ORIGINAL
 ZEICHNUNG NICHT ÄNDERN

ZEICHNUNG GESCHÜTZT DURCH
 ©COPYRIGHT 1975
 AMP DEUTSCHLAND GMBH
 ALLE RECHTE VORBEHALTEN

REV.	ÄNDERUNG	DATUM	NAME
A	925368 RELEASED FOR PROD.	01.04.76	DAHLH.
B	POLZ.x2.54-1.0 WAR POLZ.x2.54-0.2	4/76	DAHLH.
E	NEU GEZEICHNET	01.03.77	DAHLH.
F	FARBE GRÜN HINZU	4/77	DAHLH.
K	PA 6.6 WAR PA 13 GV	12.06.78	KREPP
L	-1 ENTFALLEN	06.12.78	KREPP
M	MAß 14.2 WAR 13.5	26.09.84	A.HO
N	ZEICHNUNG NEU ERSTELLT	03.07.89	A.HO
P	ZEICHNUNGS-NR. WAR 925 366-368	20.10.92	A.HO
P1	FELD FÜR GEGENSTECKER/KONTAKT: HINZU	04.08.95	A.HO
R	AMP-Logo durch tyco-Logo ersetzt	08.06.00	A. Zitz
W	Revisionsanpassung an P-Zeichnung	31.07.00	A. Zitz
W1	Zeichnung überarbeitet	24OCT00	A. Zitz

GEGENSTECKER/KONTAKT:
 MATED WITH: 826 629 167 301-4

EINREIHIG

POLZ.	L-0.2	BESTELL-NR.
-	-	-
2	5.08	925 366 -2
3	7.62	-3
4	10.16	-4
5	12.70	-5
6	15.24	-6
7	17.78	-7
8	20.32	-8
9	22.86	-9
10	25.40	1- -0
11	27.94	1- -1
12	30.48	1- -2
13	33.02	1- -3
14	35.56	1- -4
15	38.10	1- -5
16	40.64	1- -6
17	43.18	1- -7
18	45.72	1- -8
19	48.26	1- -9
20	50.80	2- -0
21	53.34	2- -1
22	55.88	2- -2
23	58.42	2- -3
24	60.96	2- -4
25	63.50	2- -5
26	66.04	2- -6
27	68.58	2- -7
28	71.12	2- -8
29	73.66	2- -9
30	76.20	3- -0
31	78.74	3- -1
32	81.28	3- -2
33	83.82	3- -3
34	86.36	3- -4
35	88.90	3- -5
36	91.44	3- -6
37	93.98	3- -7
38	96.52	3- -8
39	99.06	3- -9
40	101.60	4- -0
41	104.14	4- -1
42	106.68	4- -2
43	109.22	4- -3
44	111.76	4- -4
45	114.30	4- -5
46	116.84	4- -6
47	119.38	4- -7
48	121.92	4- -8
49	124.46	4- -9
50	127.00	5- 925 366 -0

		ZEICHNUNG GÜLTIG AB KW. 32/95	
		AMP DEUTSCHLAND G.m.b.H. Langen b.Ffm., West Germany	
		BENENNUNG	
		AMPMODU IV GEHÄUSE, EINREIHIG	
Polyamid GRÜN RAL 6011			
WERKSTOFF	OBERFLÄCHE FARBE	NICHT TOLERIERTE MASSE ± 0.2mm ± -	FORMAT A3
		ZEICHNUNGS-NR. 925366	
GEZ.	05.12.75	GEPR.	
DAHLHEIMER		KREPP	
		MASSTAB 4:1	BLATT 1 VON 1
		REV. W1	

GEZ. 05.12.75
 DAHLHEIMER

GEPR. KREPP

13:15:41 eg003977 s.925366.1.c (in EDM)

.050" PITCH FLAT CABLE

SERIES 171 – 28 AWG (7/36) STRANDED

SERIES 173 – 28 AWG SOLID

SERIES 179 – 26 AWG (7/34) STRANDED

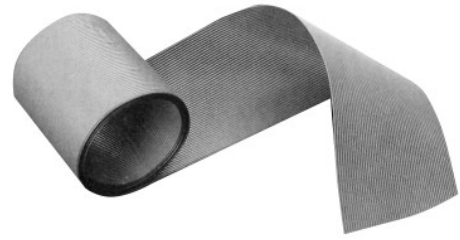

CATALOG SERIES	SPECIFICATIONS						
	171		173		179		
Wire Size AWG	28 Stranded		28 Solid		26 Stranded		
Insulation Material	PVC		PVC		PVC		
Conductor Spacing mm (in)	1.27 (.050)		1.27 (.050)		1.27 (.050)		
Temperature Rating (°C)	105		105		105		
Voltage Rating (RMS)	300		300		300		
Impedance Ohms	100		105		93		
Capacitance pF/M (pF/FT)	46 (14)		44.3 (13.5)		49.5 (15.1)		
Inductance μH/M (μH/FT)	.46 (.14)		.49 (.15)		.43 (.13)		
Velocity of Propagation nS/M (nS/FT)	4.53 (1.38)		4.53 (1.38)		4.43 (1.35)		
Insulation Resistance Ohms/Ft	10 ¹⁰		10 ¹⁰		10 ¹⁰		
Typical Crosstalk Characteristics	Rise Time nSec	3.0	7.0	3.0	7.0	3.0	7.0
	Near End (%)	5.0	3.2	4.8	3.1	5.2	3.8
10FT Sample 1 line driven	Far End (%)	6.7	2.7	7.3	2.9	6.1	2.3
	UL Style No.	2651		2651		2651	

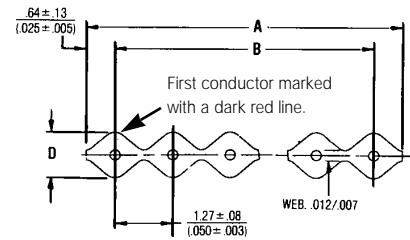

Accumulation of pitch tolerance between conductors in entire cable may not exceed tolerance of dim. "B".

CABLE SERIES	DIMENSIONS IN MM (INCHES)	
	D	
171	.91 (.036)	
173	.91 (.036)	
179	1.02 (.040)	

Ordering Information

28 GAUGE STRANDED	CATALOG NUMBERS		NO. OF POS.	DIMENSIONS IN MM (INCHES)		
	28 GAUGE SOLID	26 GAUGE SOLID		A	B	B TOLERANCE
171-10ED	173-10	—	10	12.70 (.500)	11.43 (.450)	± .18 (±.007)
171-12	—	—	12	15.24 (.600)	13.97 (.550)	
171-14	173-14	179-14	14	17.78 (.700)	16.51 (.650)	
171-15	173-15	—	15	19.05 (.750)	17.78 (.700)	± .25 (±.010)
171-16	173-16	—	16	20.32 (.800)	19.05 (.750)	
171-20	173-20	—	20	25.40 (1.000)	24.13 (.950)	
171-24ED	173-24	179-24	24	30.48 (1.200)	29.21 (1.150)	
171-25	173-25	—	25	31.75 (1.250)	30.48 (1.200)	
171-26	173-26	—	26	33.02 (1.300)	31.75 (1.250)	
171-28	—	—	28	35.56 (1.400)	34.29 (1.350)	± .38 (±.015)
171-30ED	—	—	30	38.10 (1.500)	36.83 (1.450)	
171-34	173-34	—	34	43.18 (1.700)	41.91 (1.650)	
171-36	—	179-36	36	45.72 (1.800)	44.45 (1.750)	
171-37	173-37	—	37	46.99 (1.850)	45.72 (1.800)	
171-40ED	173-40	—	40	50.80 (2.000)	49.53 (1.950)	
171-44	173-44	—	44	55.88 (2.200)	54.61 (2.150)	
171-50	173-50	179-50	50	63.50 (2.500)	62.23 (2.450)	± .38 (±.015)
171-56	173-56	—	56	71.12 (2.800)	69.85 (2.750)	
171-60	173-60	—	60	76.20 (3.000)	74.93 (2.950)	
171-64	—	—	64	81.28 (3.200)	80.01 (3.150)	