

SPECIFICATIONS	
UNITS	MILLIMETERS
TOLERANCES	± 0.1 mm UNLESS STATED
MATERIAL	1.5mm Steel Zinc Seal
FINISH	Phosphate Passivate

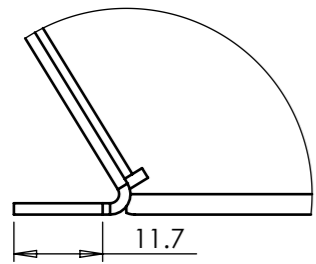

DETAIL B
SCALE 1 : 1

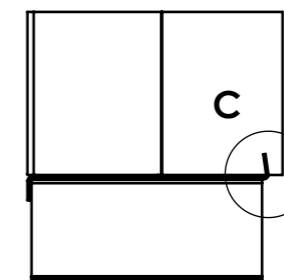
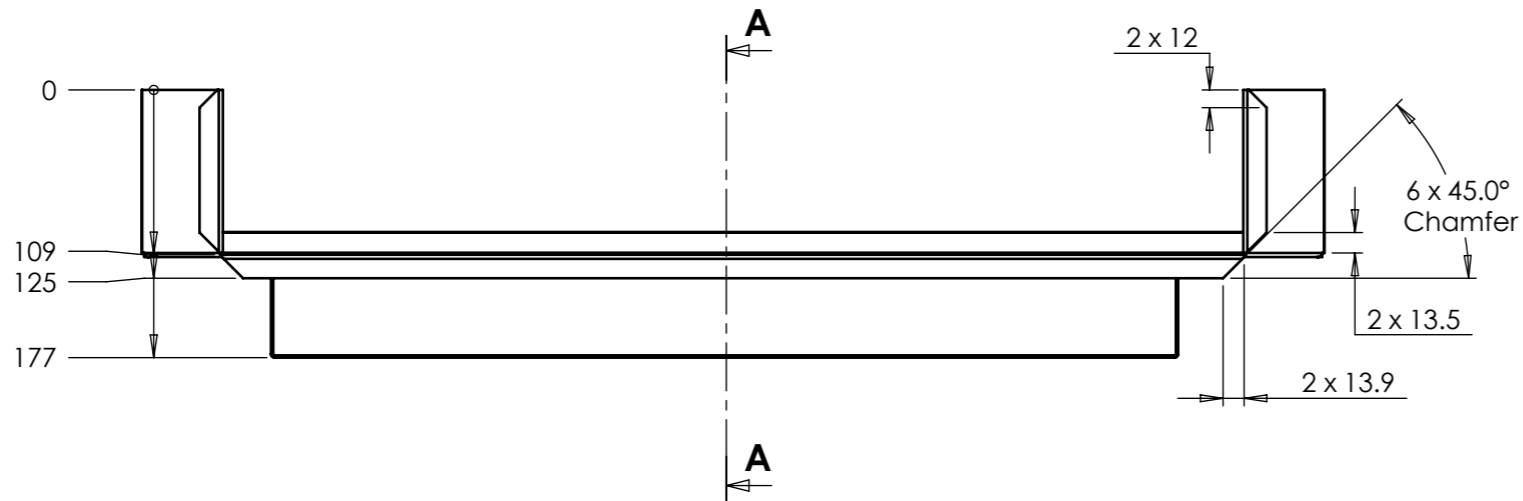
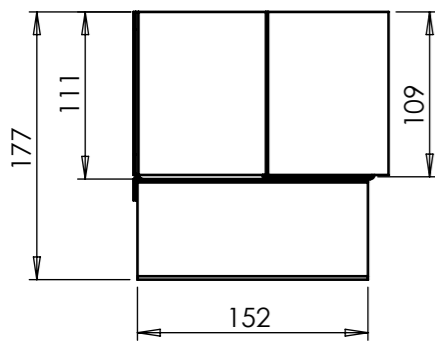
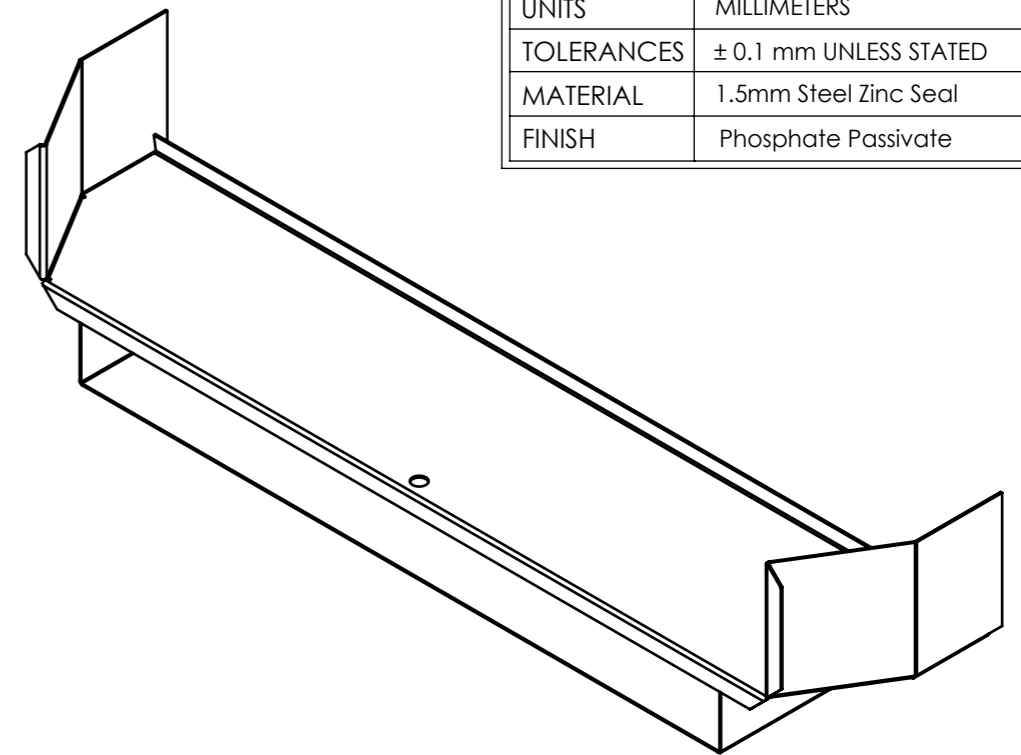
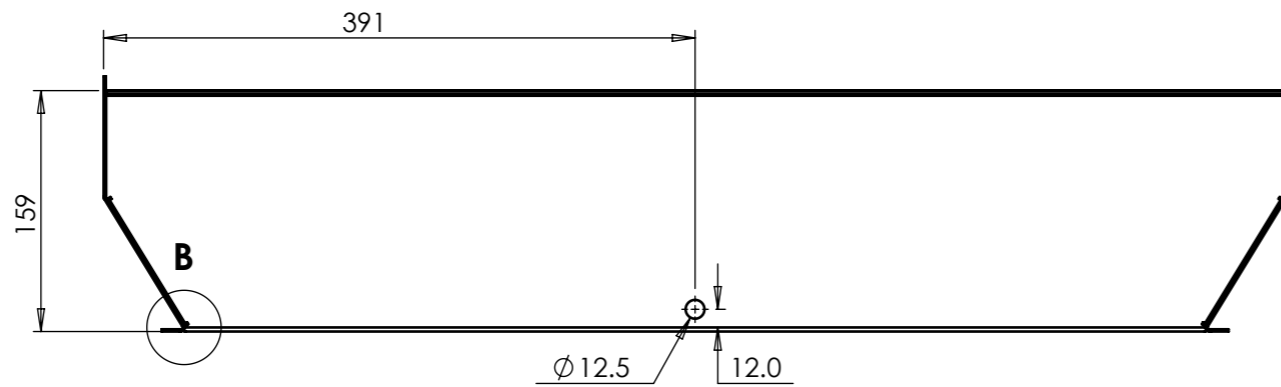

SECTION A-A

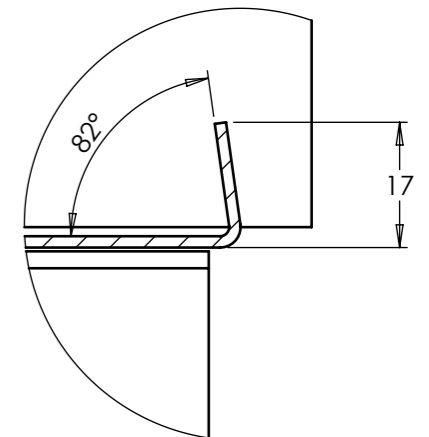

DETAIL C
SCALE 1 : 1

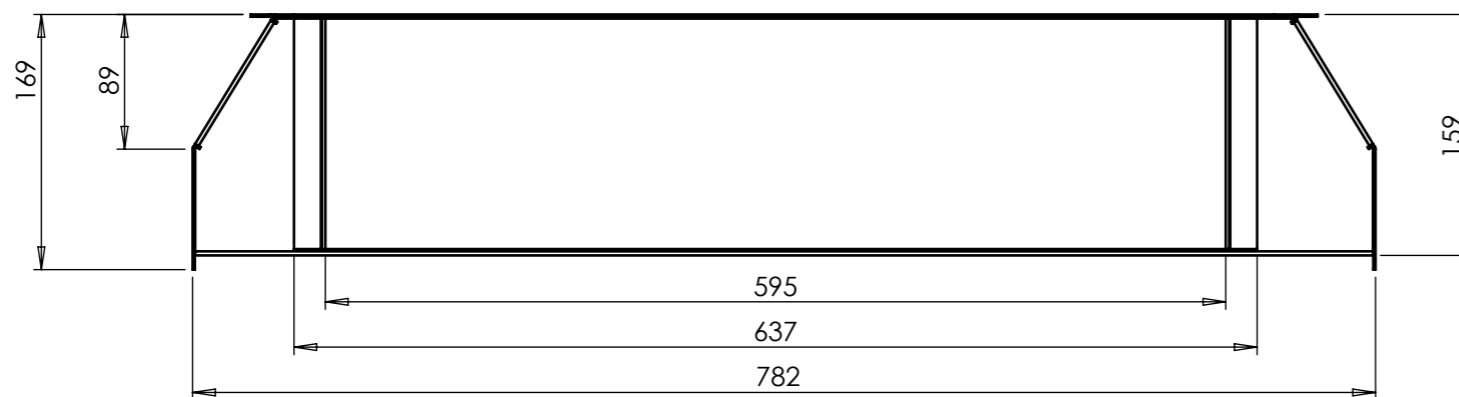

REVISIONS

ZONE	REV.	DESCRIPTION	DATE	APPROVED
	B	1. Modified 2 piece construction design. 2. Length/Width modification. 3. Change to top piece angular flanges, detailed in the construction diagrams shown on sheet 2.	29/4/2010	
	C	1. Addition \varnothing 12.5 Hole In Top Face	21/07/2010	

PSI POSEIDON SCIENTIFIC INSTRUMENTS
17 QUEEN VICTORIA ST, FREMANTLE WA 6160 PH: (08) 9430 6639 FAX (08) 9335 4650

DRAWING NAME MWAM013 Flow Splitter			
SIZE A3	DRAWN BY C.Coleman	DRAWING FILENAME. MWAM013 Flow splitter.SLDDRW	
SCALE 1:5	DATE 21/07/2010	COMPONENT NAME MWAM013 Flow Splitter.SLDPR	REV C
SHEET 1 of 2			

SPECIFICATIONS	
UNITS	MILLIMETERS
TOLERANCES	± 0.1 mm UNLESS STATED
MATERIAL	1.5mm Steel Zinc Seal
FINISH	Phosphate Passivate

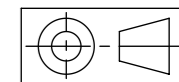
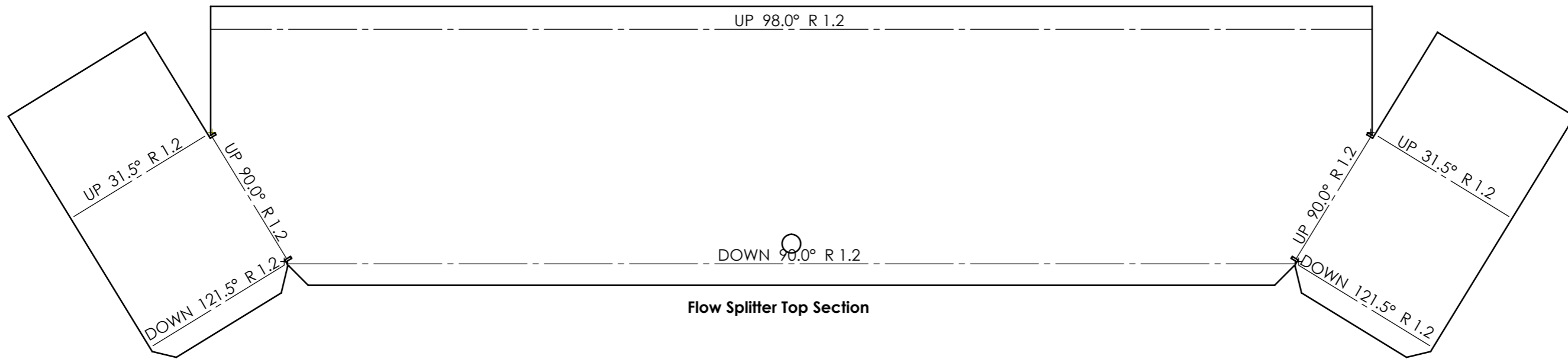

Note: Suggested two piece construction configuration

POSEIDON SCIENTIFIC INSTRUMENTS <small>17 QUEEN VICTORIA ST, FREMANTLE WA 6160 PH: (08) 9430 6639 FAX (08) 9335 4650</small>			
DRAWING NAME			
MWAM013 Flow Splitter			
SIZE	DRAWN BY	DRAWING FILENAME.	
A3	C.Coleman	MWAM013 Flow splitter.SLDDRW	
SCALE	DATE	COMPONENT NAME	REV
1:3	21/07/2010	Flow Splitter Bottom/Top Sections	C
SHEET			
2 of 2			