

REVISIONS				
ECO	REV.	DESCRIPTION	DATE	APPROVED
32-117	01	INITIAL RELEASE	4/27/2006	

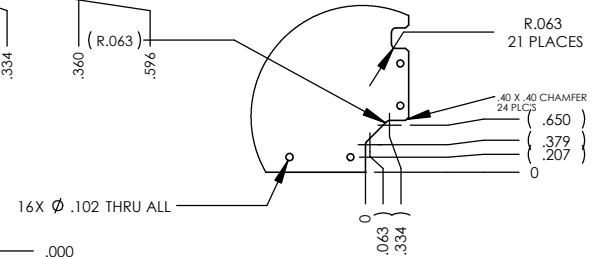
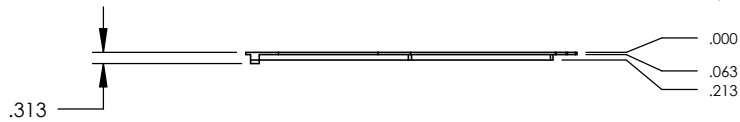
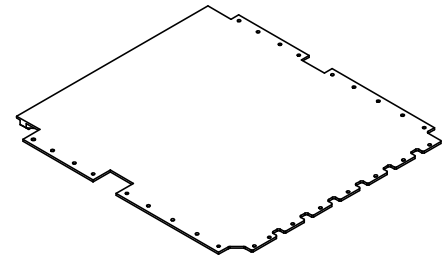
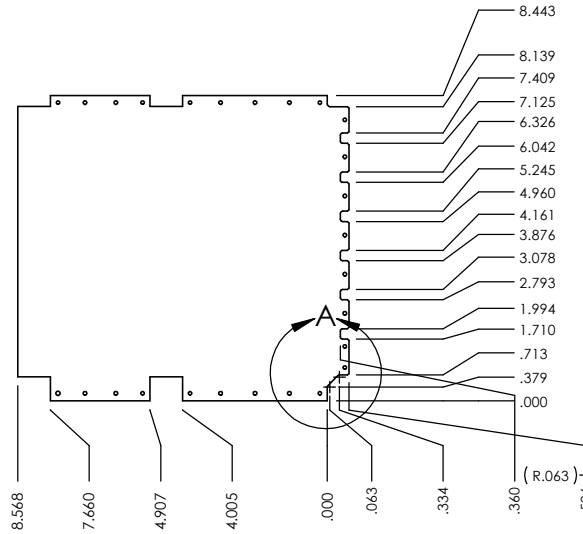
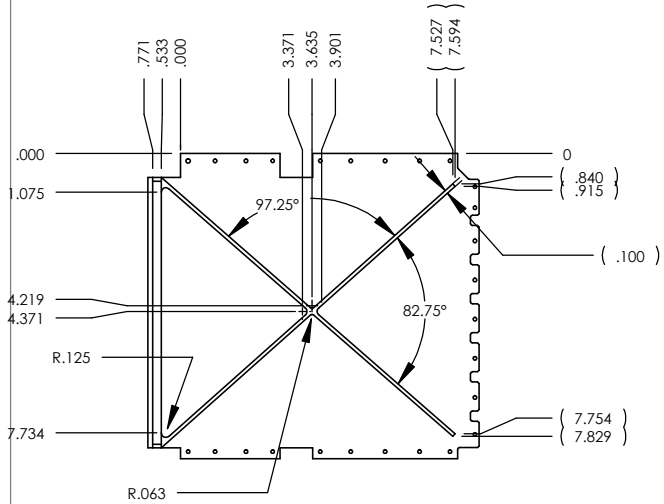

DETAIL A  
SCALE 2 : 5

**PROPRIETARY AND CONFIDENTIAL**  
THE INFORMATION CONTAINED IN THIS DRAWING IS THE SOLE PROPERTY OF <INSERT COMPANY NAME HERE>. ANY REPRODUCTION IN PART OR AS A WHOLE WITHOUT THE WRITTEN PERMISSION OF <INSERT COMPANY NAME HERE> IS PROHIBITED.

		DIMENSIONS ARE IN INCHES TOLERANCES: FRACTIONAL ± ANGULAR: MACH ± BEND ± TWO PLACE DECIMAL ± THREE PLACE DECIMAL ±	NAME	DATE
		MATERIAL ALUM. 7075-T651	DRAWN	
		FINISH CHEM FILM PER MIL-C-5541, CL3	CHECKED	
NEXT ASSY	USED ON		ENG APPR.	
			MFG APPR.	
			Q.A.	
APPLICATION	DO NOT SCALE DRAWING		COMMENTS:	

MIT, CRATER PROJECT

COVER, BOTTOM

SIZE <b>A</b>	DWG. NO. <b>32-20205</b>	REV. <b>01</b>
SCALE: 1:5	WEIGHT:	SHEET 1 OF 2

REVISIONS				
ECD	REV.	DESCRIPTION	DATE	APPROVED
32-117	01	INITIAL RELEASE	-	-

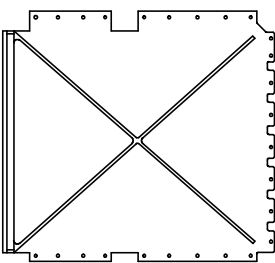
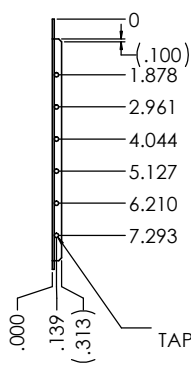
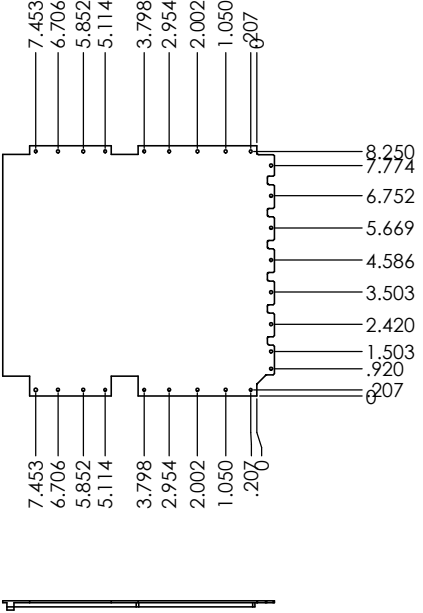

6X  $\phi$  .120  $\nabla$  .438  
TAP FOR #4-40 HELICOIL Insert = 2.0 \* Dia.

- NOTES:  
 1. DEBURR AND BREAK SHARP EDGES  
 2. INSIDE RADIUS TO BE .005 MAX.  
 3. BAG AND TAG WITH MIT PART NUMBER AND REV LETTER.

IMPORTANT: THIS DOCUMENT IS UNCLASSIFIED UNLESS INDICATED OTHERWISE. ANY INFORMATION CONTAINED HEREIN IS UNCLASSIFIED EXCEPT WHERE SHOWN OTHERWISE.

UNLESS OTHERWISE SPECIFIED:	DESIGNER	NAME	DATE	MIT, CRATER PROJECT
DIMENSIONS ARE IN INCHES	CHECKED			
TOLERANCES UNLESS OTHERWISE SPECIFIED:	ENG APPR.			TITLE:
ANGLES UNLESS OTHERWISE SPECIFIED:	ENG APPR.			COVER, BOTTOM
FINISHES UNLESS OTHERWISE SPECIFIED:	D.A.			SIZE
THREADS UNLESS OTHERWISE SPECIFIED:	COMMENTS:			DWG. NO.
ASSEMBLY UNLESS OTHERWISE SPECIFIED:				32-20205
NEW PART	USED ON			REV
APPROVAL				01
				SHEET 2 OF 2
				SCALE: 1:2 (WEIGHT)

32-20205 D