

| REVISIONS | | | | | |
|-----------|---------|-----------------|---------|----------|------|
| REV. | ECO NO. | DESCRIPTION | CHECKED | APPROVED | DATE |
| A | 36-539 | INITIAL RELEASE | | | |

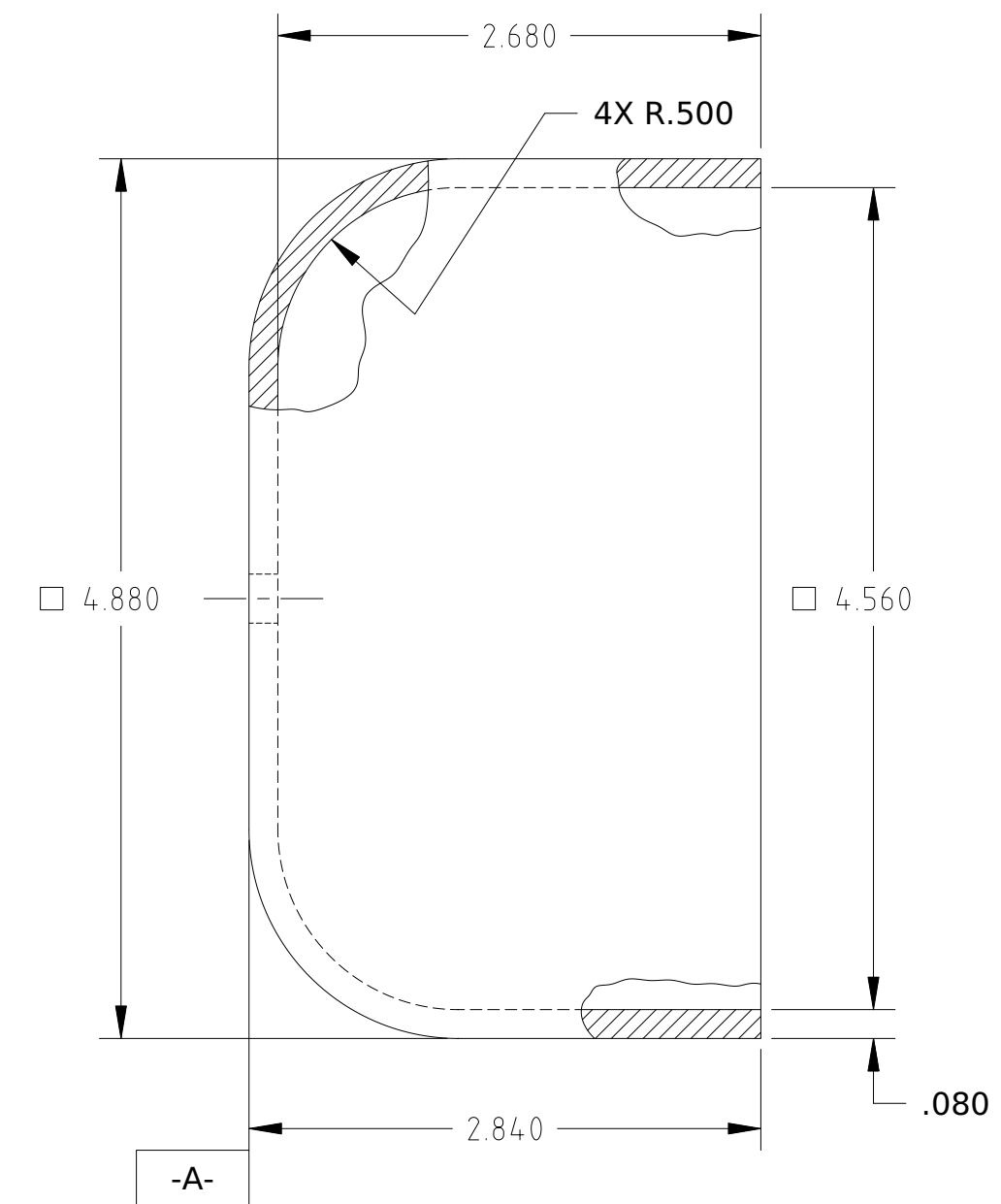
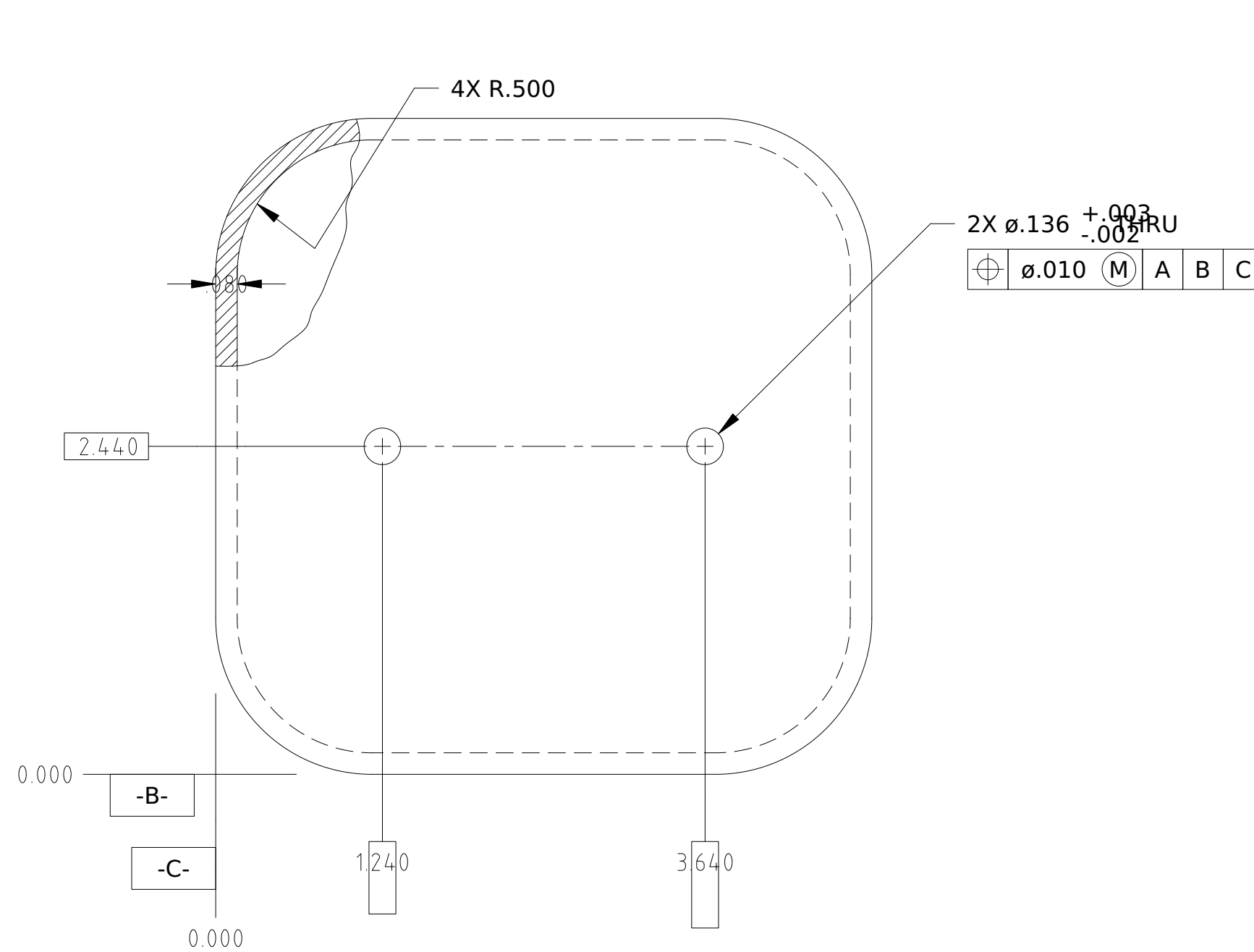

NOTES:

1. MATERIAL: CDA1450 HD CU ROD PER ASTM B301.
2. BREAK SHARP EDGES .01 RADIUS.
3. MACHINED SURFACES $\sqrt{125}$ MAX

| | | | | | | | | |
|---------------|---------|--|----------|---------|---|--|----------|--------|
| | | UNLESS OTHERWISE SPECIFIED DIMENSIONS ARE IN INCHES TOLERANCE: ANGLES $\pm 1^\circ$ 3 PLACE DECIMALS $\pm .005$ 2 PLACE DECIMALS $\pm .01$ | NAME | DATE | MASSACHUSETTS INSTITUTE OF TECHNOLOGY CENTER FOR SPACE RESEARCH CAMBRIDGE, MA 02139 | | | |
| | | | DRAWN | J. COOK | 9/9/94 | EXTERNAL CALIBRATION SOURCE COPPER SHIELD | | |
| | | MATERIAL | CHECKED | | SIZE | | | |
| 36-40200 | ACIS | SEE NOTE 1 | APPROVED | | C | 80230 | 36-40206 | A |
| NEXT ASSEMBLY | USED ON | INTERPRET DIMENSIONS AND TOLERANCES IAW ANSI Y14.5M-1982 | RELEASED | | SCALE: | 2/1 | SHEET | 1 OF 1 |
| APPLICATION | | | WEIGHT | | | | | |