

REVISIONS						
REV.	ECO NO.	DISCRIPTION		CHECKED	APPROVED	DATE
A	36-311	INITIAL RELEASE	PCT	RFG	9/27/95	
B	36-453	SEE ECO 36-453				

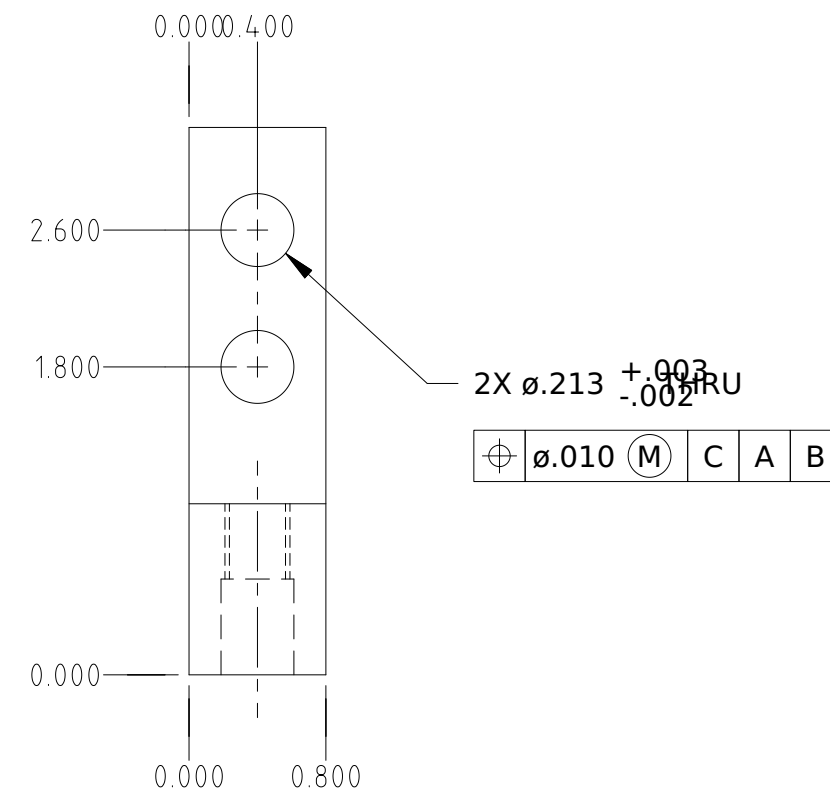
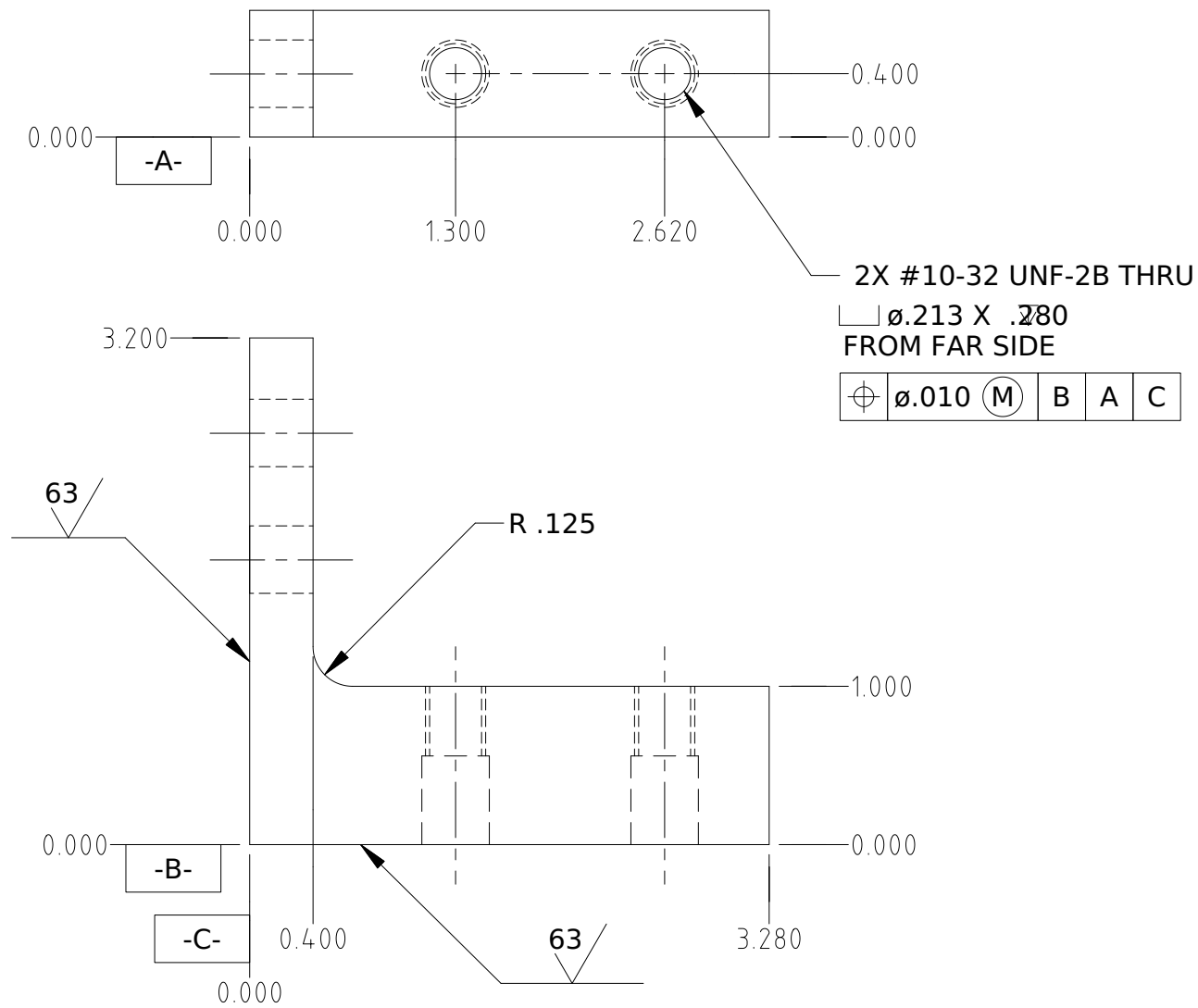

**NOTES:**

1. DEBURR AND BREAK SHARP EDGES, .01 MAX.
2. MACHINED SURFACES 125 MAX EXCEPT AS NOTED.
3. CONVERSION COAT PER MIL-C-5541, CLASS 3.

		UNLESS OTHERWISE SPECIFIED DIMENSIONS ARE IN INCHES TOLERANCE: ANGLES ± 1° 3 PLACE DECIMALS ± .005 2 PLACE DECIMALS ± .01	NAME	DATE	MASSACHUSETTS INSTITUTE OF TECHNOLOGY CENTER FOR SPACE RESEARCH CAMBRIDGE, MA 02139				
			DRAWN	J. COOK	5/15/95	<b>SUPPORT BRACKET UPPER +Y &amp; -Y</b>			
			CHECKED	P.C. TAPPAN	9/18/95				
			APPROVED	R.F. GOEKE	9/27/95				
		MATERIAL	RELEASED	D. GAGE	9/27/95	SIZE	FSCM NO.	DWG. NO.	REV.
36-30100		ACIS	6061-T6 ALUMINUM			<b>B</b>	<b>80230</b>	<b>36-30108</b>	<b>B</b>
NEXT ASSEMBLY		USED ON	WEIGHT			SCALE		SHEET	
APPLICATION						2/1		1 OF 1	