

REVISIONS					
REV.	ECO NO.	DISCRIPTION	CHECKED	APPROVED	DATE
A	36-452	INITIAL RELEASE			
B	36-677	REVISED PER ECO 36-677			

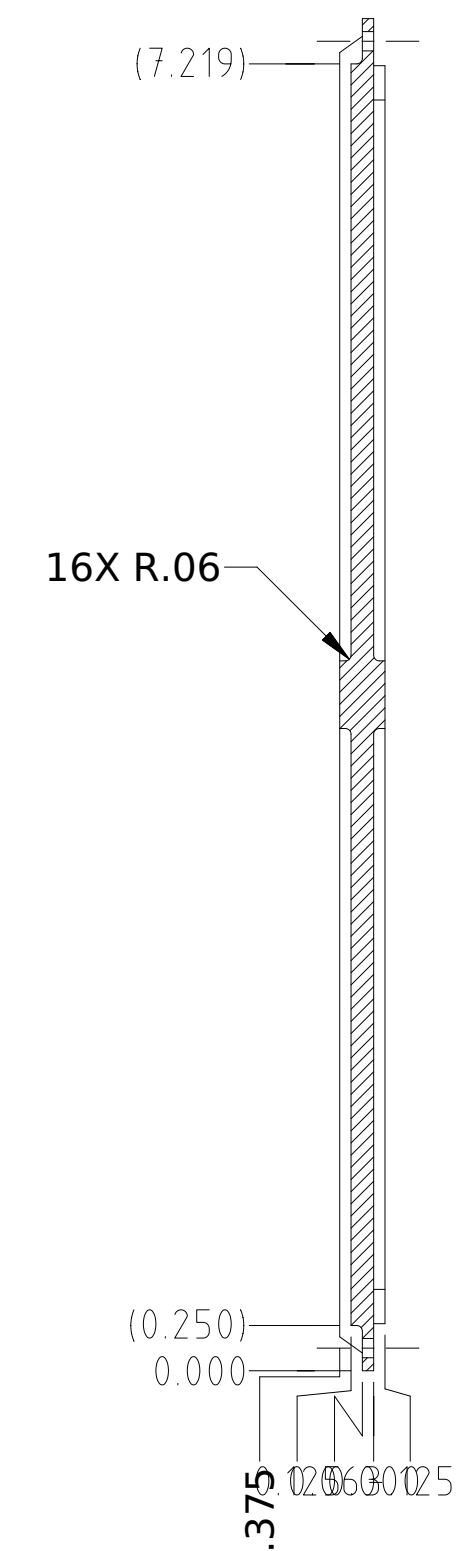
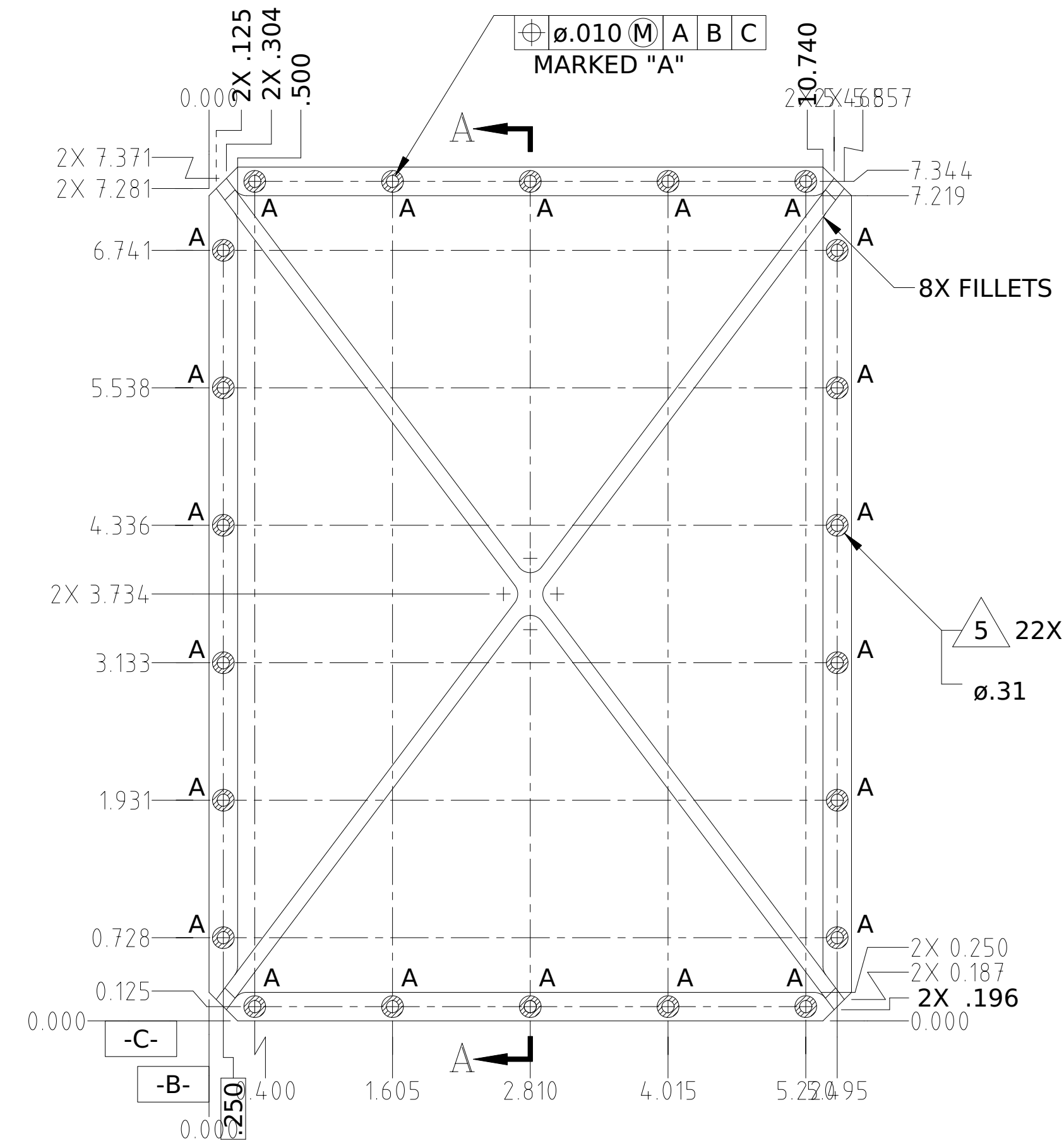
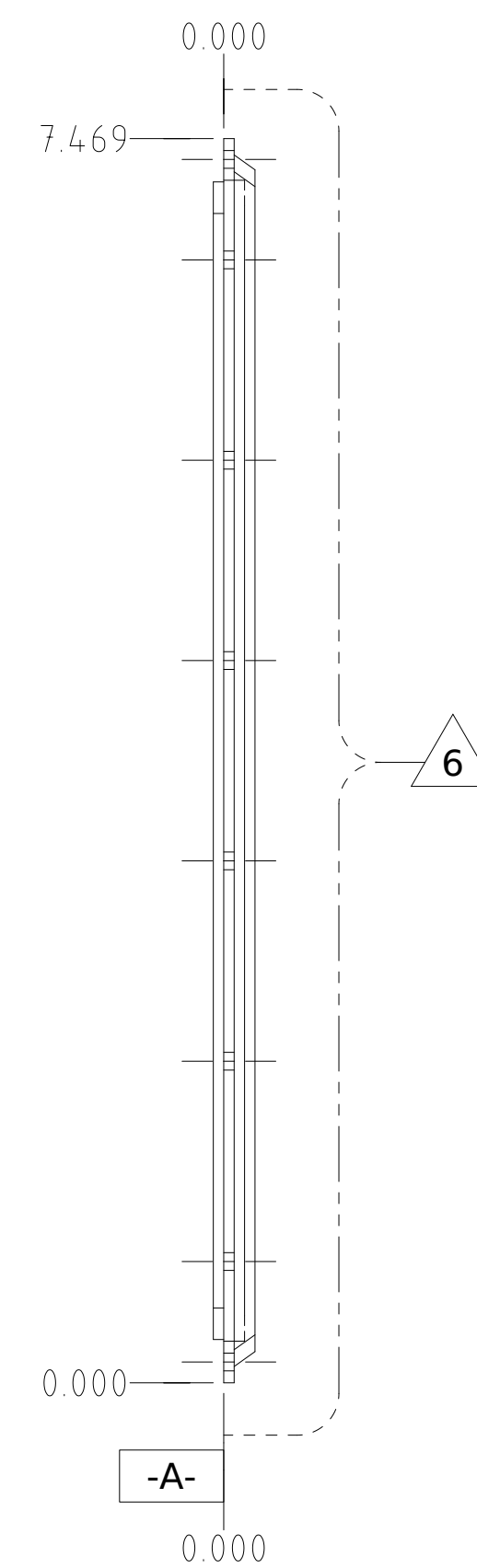
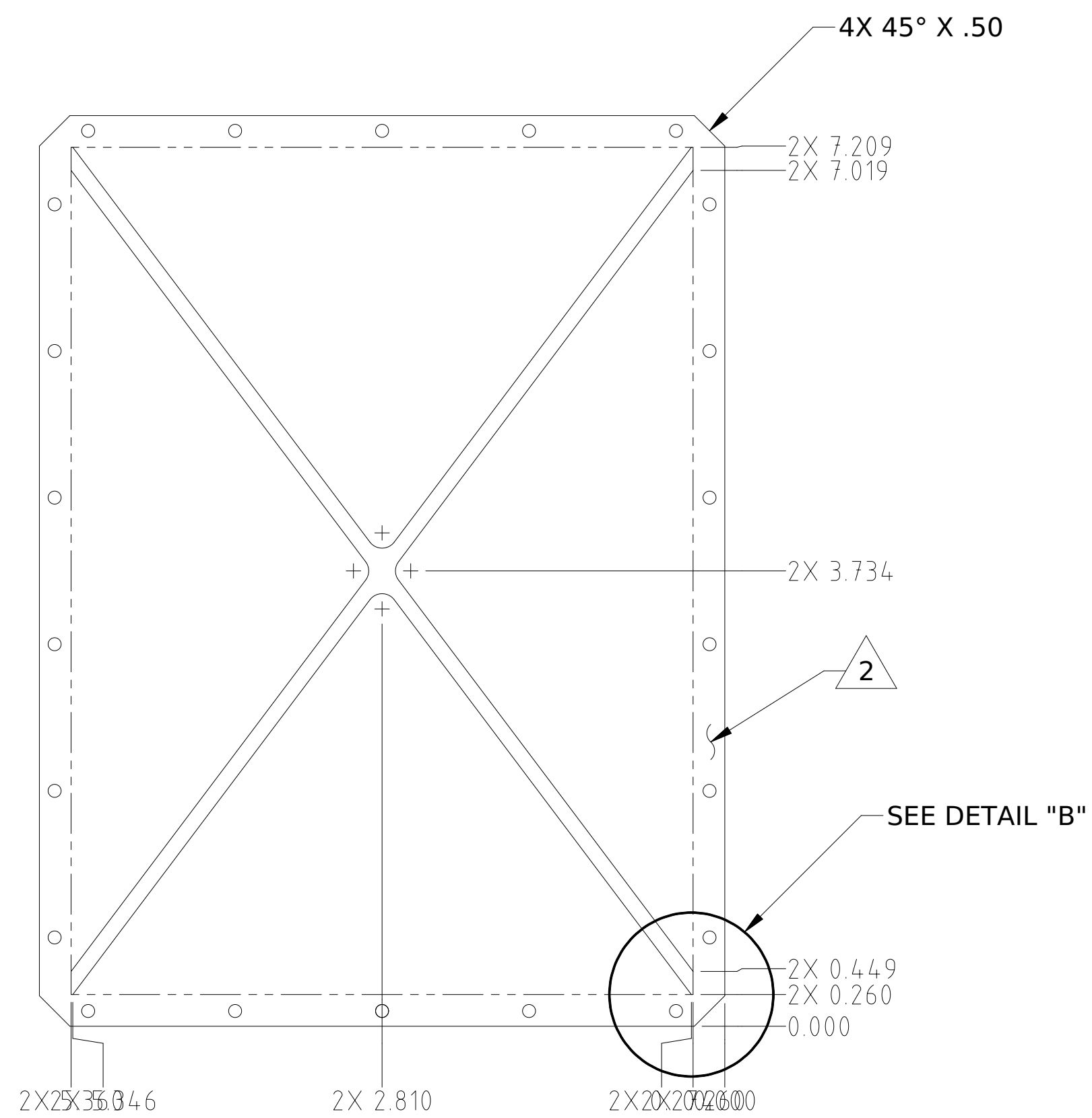
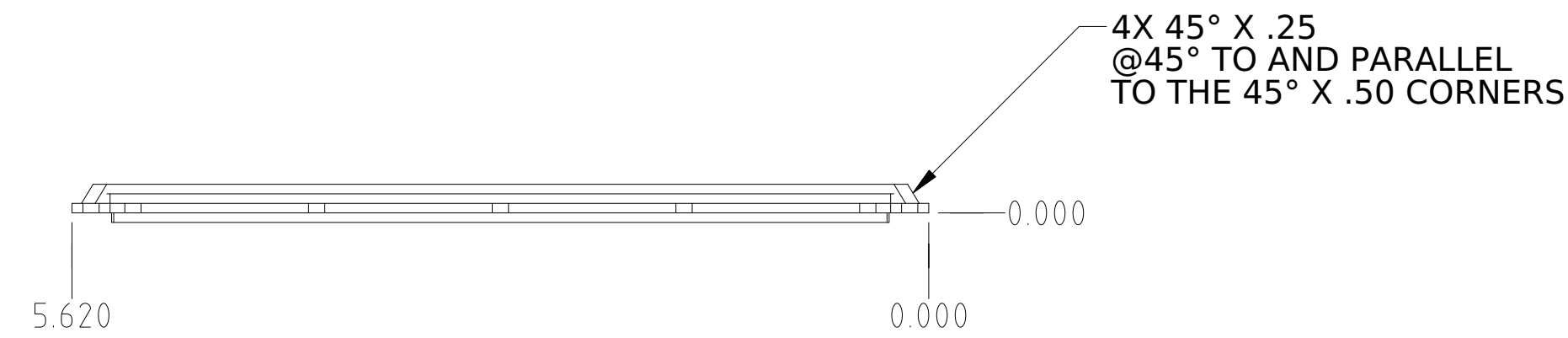

SECTION A-A
SCALE: 1/2

NOTES:

- ALL FILLETS SHOWN TO BE R.25 UNLESS OTHERWISE SPECIFIED. OTHER INTERNAL CORNERS TO BE R.06.
- MACHINED SURFACES 125 MAX. EXCEPT OUTSIDE OF PHANTOM LINE TO BE 63 MAX.
- DEBURR AND BREAK SHARP EDGES.
- CONVERSION COAT PER MIL-C-5541, CLASS 3.
- MASK HOLES AND MOUNTING SURFACE AS INDICATED. EDGES NOT DIMENSIONED ARE TO CONFORM TO PART OUTLINE.
- PREPARE INDICATED SURFACE WITH AEROGLAZE WASH PRIMER 9924. PAINT WITH AEROGLAZE Z306 BLACK PER 36-02028.
- HANDLE WITH POWDER FREE, CONTAMINATION FREE GLOVES DURING ALL POST PAINTING OPERATIONS.

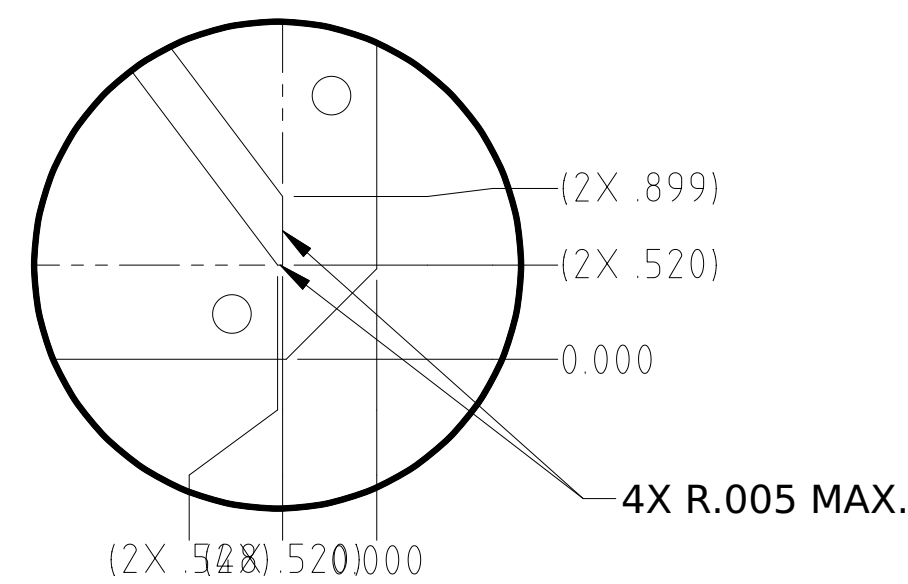

DETAIL B
SCALE: 1/1

HOLE CHART		
HOLE	DESCRIPTION	QTY
A	ø.211-.216 THRU	22

APPLICATION		MATERIAL
36-30100	ACIS	ALUMINUM 6061-T651
NEXT ASSEMBLY	USED ON	

NAME	DATE	MASSACHUSETTS INSTITUTE OF TECHNOLOGY CENTER FOR SPACE RESEARCH CAMBRIDGE, MA 02139		
DRAWN J. COOK	4/19/95	SUPPORT STRUCTURE -X		
CHECKED P.C. TAPPAN	2/1/96			
APPROVED R.F. GOEKE	2/1/96			
RELEASED D.GAGE	2/1/96			
SIZE D	FSCM NO. 80230	DWG. NO. 36-30101	REV. B	
SCALE 1/2	SHEET 1 OF 1			