

| REVISIONS |         |                   |         |          |        |
|-----------|---------|-------------------|---------|----------|--------|
| REV.      | ECD NO. | DESCRIPTION       | CHECKED | APPROVED | DATE   |
| A         | 30-006  | INITIAL RELEASE   | EAB     | RF       | 7/9/02 |
| B         | 30-013  | ADD MISSING RADII |         |          |        |

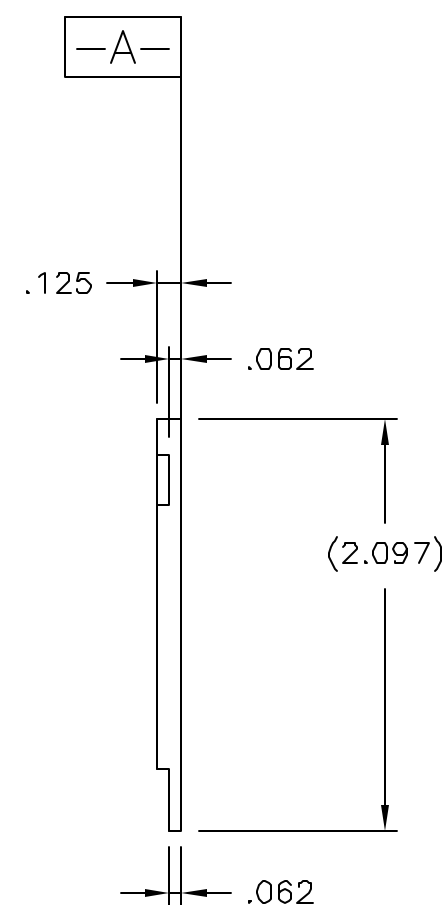
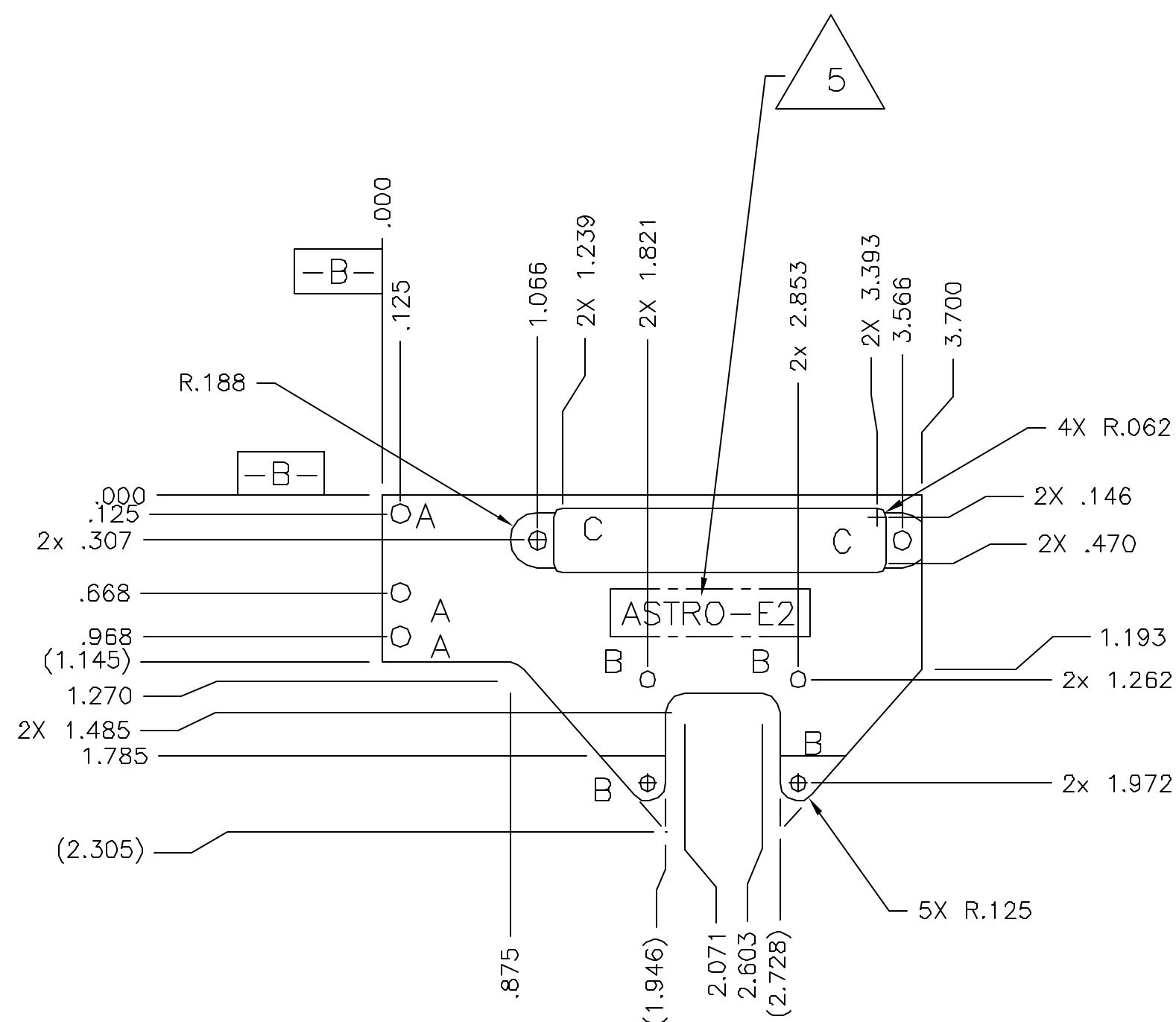

| HOLE CHART |     |  |  |
|------------|-----|--|--|
| HOLE       | QTY | TOLERANCE                                | DESCRIPTION  |
| A          | 3   | $\varnothing \phi.010 \text{ (M) A B C}$ | $\phi.128 \begin{matrix} +.003 \\ -.002 \end{matrix}$ THRU |
| B          | 4   | $\varnothing \phi.010 \text{ (M) A B C}$ | $\phi.110 \begin{matrix} +.003 \\ -.002 \end{matrix}$ THRU |
| C          | 2   | $\varnothing \phi.010 \text{ (M) A B C}$ | $\phi.125 \begin{matrix} +.003 \\ -.002 \end{matrix}$ THRU |

NOTES:

1. MATERIAL: ALUMINUM ALLOY 6061-T6.
2. REMOVE ALL BURRS AND SHARP EDGES R.010 MAXIMUM.
3. UNTOLERANCED DIMENSIONS LOCATING TRUE POSITION ARE BASIC.
4. FINISH: ELECTROLESS NICKEL PLATE PER ASTM B 733-TBD, SC1, TYPE I, CLASS 4, AIMg1Si0.6/NiP 5, 200±50 MICRO INCHES THICK. MAXIMUM PHOSPHORUS CONTENT OF THE NICKEL DEPOSIT SHALL BE 8% BY MASS.
5. ENGRAVE IN .25 HIGH CHARACTERS APPROX. WHERE SHOWN.

|                  |          | NAME     | DATE    |
|------------------|----------|----------|---------|
| DRAWN            |          | M. Smith | 6/22/02 |
| CHECKED          |          | Ed B.    | 7/1/02  |
| APPROVED         |          | Rick F.  | 7/9/02  |
| RELEASED         |          | Deb G.   | 7/10/02 |
| 30-50114         | ASTRO-E2 |          |         |
| NEXT HIGHER ASSY | USED ON  | WEIGHT   |         |

UNLESS OTHERWISE SPECIFIED:  
 DIMENSIONS SHALL BE INTERPRETED IAW ANSI Y14.5 - 1982  
 DIMENSIONS ARE IN INCHES  
 TOLERANCE: ANGLES ±1°  
 3 PLACE DECIMALS ±.005  
 2 PLACE DECIMALS ±.01  
 THIRD ANGLE PROJECTION

MASSACHUSETTS INSTITUTE OF TECHNOLOGY  
 CENTER FOR SPACE RESEARCH  
 CAMBRIDGE, MA 02139

**PLATE, CONNECTOR  
 CCD TEST FIXTURE, ASTRO E2**

|      |           |             |      |
|------|-----------|-------------|------|
| SIZE | CAGE CODE | DWG. No.    | REV. |
| C    | 80230     | 30-50114.05 | B    |

SCALE 1:1 SHEET 1 OF 1